

**CITY OF TWIN OAKS
BOARD OF ALDERMEN WORK SESSION
VIDEO CONFERENCE MEETING
WEDNESDAY, June 17, 2020, 6:15 p.m.**

In view of the state of emergencies declared by the federal, state, county and City because of the global pandemic COVID-19, as well as the public health orders issued by the St. Louis County Health Department, in accord with the provisions of Twin Oaks Code §120.070 and §610.020, RSMo., the Board of Aldermen of City of Twin Oaks understands that it would be impossible and impractical—and possibly dangerous—for its meeting to be physically accessible to the public during this time.

To balance both the need for continuity of government and protection of the health and safety of our residents, business persons and employees, this meeting of the Board of Aldermen will not be open to public attendance *in person* but shall be accessible by the public by telephone (audio only) or by using their tablet/laptop/pc (audio/video) at:

Telephone: (312) 626-6799
Computer: <https://us02web.zoom.us/j/5197276201>
Webinar ID: 519-727-6201

The Board apologizes for any inconvenience the meeting format change may pose but it is extremely important all measures in compliance with the orders issued by public health authorities be taken to protect employees, residents, and elected officials during these extraordinary times.

The Agenda Packet for this meeting is available for viewing and download on the City's Website – www.cityoftwinoaks.com.

Tentative Agenda

- 1) MERAMEC STATION ROAD STRIPING
- 2) CRESCENT ROAD FOOTBRIDGE
- 3) GOLDEN OAK LIGHTING
- 4) BOLY LIGHTING

Frank Johnson
City Clerk

POSTED: June 15, 2020, 2:00 p.m.

Please note: Any person requiring physical or verbal accommodations should contact the city office 12 hours prior to meeting at 636-225-7873. Copies of public records for this agenda are available for public inspection before and at the time of the meeting.

Memo to: Board of Aldermen
From: Frank Johnson, City Clerk
Subject: Striping of Meramec Station Road
Date: June 12, 2020

BOARD ACTION REQUIRED

- Finalize the specifications of the proposed bike lane on Meramec Station Road and/or appoint a liaison from the board to work with the contractor.

BACKGROUND

City staff discussed the proposed striping project with BFA and requested a basic plan be drafted to indicate the approximate location of the bike lane. This information was provided to Traffic Control Company and AFK Safety Solutions for cost estimates.

The plan proposes removing and restriping the existing shoulder marking from Crescent Avenue to the shopping center access road just south of Hardees and the addition of two bike lane symbols as the simplest method. However, the Board may wish to consider additional striping or other modifications to the scope of the project.

If that is the case, staff recommends that the Board appoint a member as a liaison to meet with the contractor ahead of the work being started to ensure that it meets the City's expectations and specifications.

MERAMEC STATION ROAD BIKE LANE STRIPING PLAN

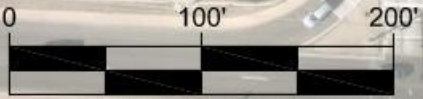

SCALE: 1" = 100'

NOTES:

1. RESTRIPE THE THE EXISTING WHITE LINE PER LIMITS SHOWN ON THE PLAN
2. ADD BIKE SYMBOLS ON THE WEST SIDE OF MERAMEC STATION ROAD PER MUTCD SPACING.
3. ALL STRIPING TO MEET MUTCD AND ST. LOUIS COUNTY STANDARDS.
4. SCALE IS BASED ON GOOGLE EARTH MEASUREMENTS AND SHOULD BE CONSIDERED APPROXIMATE.

D:\3497 City of Twin Oaks, MO\3497-13 Sidewalks\3497-13B Bike Lane Striping on Meramec Station Rd\CAD\Bike Lane Striping Plan.dwg
6/10/2020 2:32 PM

BIG BEND RD

WHITE STRIPE

ANN AVE

BIKE LANE
SYMBOL

WHITE STRIPE

QUINETTE DR

BIKE LANE
SYMBOL

WHITE STRIPE

CRESCENT AVE

bfaeng.com

TELEPHONE: (636) 239-4751

BFA
Engineering • Surveying

103 ELM STREET

WASHINGTON, MISSOURI 63090

Memo to: Board of Aldermen
From: Frank Johnson, City Clerk
Subject: Crescent Road Footbridge
Date: June 12, 2020

BOARD ACTION REQUIRED

- Authorize surveying and engineering work required by MSD. If a decision is made to not authorize the work, consider alternative locations or uses for the wooden footbridge.

BACKGROUND

On June 4, staff emailed information to MSD and the U.S. Army Corps of Engineers on the proposed work for installing the wooden footbridge in the forested area north of Crescent Road. The U.S. Army Corps responded that no permit was required from their agency.

However, MSD informed the City that the proposed location is near a sanitary sewer line and more detailed information must be submitted for a formal review process. Meeting these requirements will likely add significant costs to this project. The information requested by MSD includes:

- Field survey and detailed plan showing existing channel and contours, existing topography for the area, existing sewers, existing concrete slabs to be removed, proposed bridge, proposed bridge piers, and any existing easements.
- Cross section of channel and bridge and indication no filling in channel.
- Photos of the area.

MSD is requesting that the information be submitted by the city's engineer. The City does have fee reciprocity with MSD, so there would be no submittal or plan review fees.

In addition, MSD noted that while the above may seem like a lot for a wooden footbridge, they have concerns about possible conflicts and need to be sure of the exact location of the bridge in relation to existing sewers and easements.

The Metropolitan St. Louis Sewer District



6/12/2020 9:07:47 AM
RIVER 4.0



1 inch = 100 feet

Disclaimer: This map was prepared by MSD from available information and for its exclusive use. It is not intended to be used or relied upon by others. MSD makes no representation of either the accuracy or the completeness of its contents. Flood data source: Q3 (FEMA). Determination in regard to locations within or near the Special Flood Hazard Area must be confirmed by referencing the printed copy.



The Metropolitan St. Louis Sewer District

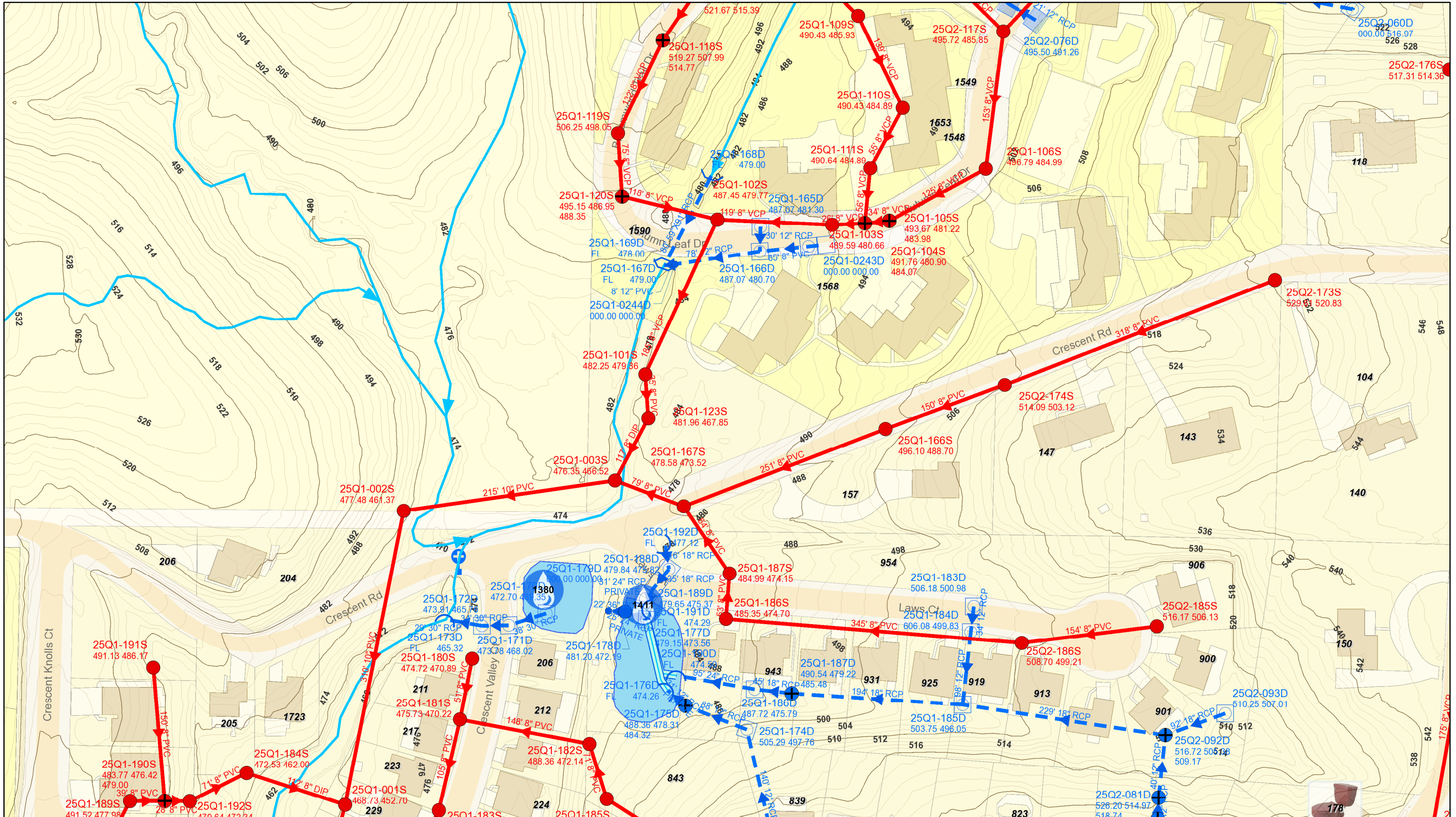

6/12/2020 8:35:52 AM
RIVER 4.0



1 inch = 100 feet

Disclaimer: This map was prepared by MSD from available information and for its exclusive use. It is not intended to be used or relied upon by others. MSD makes no representation of either the accuracy or the completeness of its contents. Flood data source: Q3 (FEMA). Determination in regard to locations within or near the Special Flood Hazard Area must be confirmed by referencing the printed copy.

